

Key plan
Scale: nts

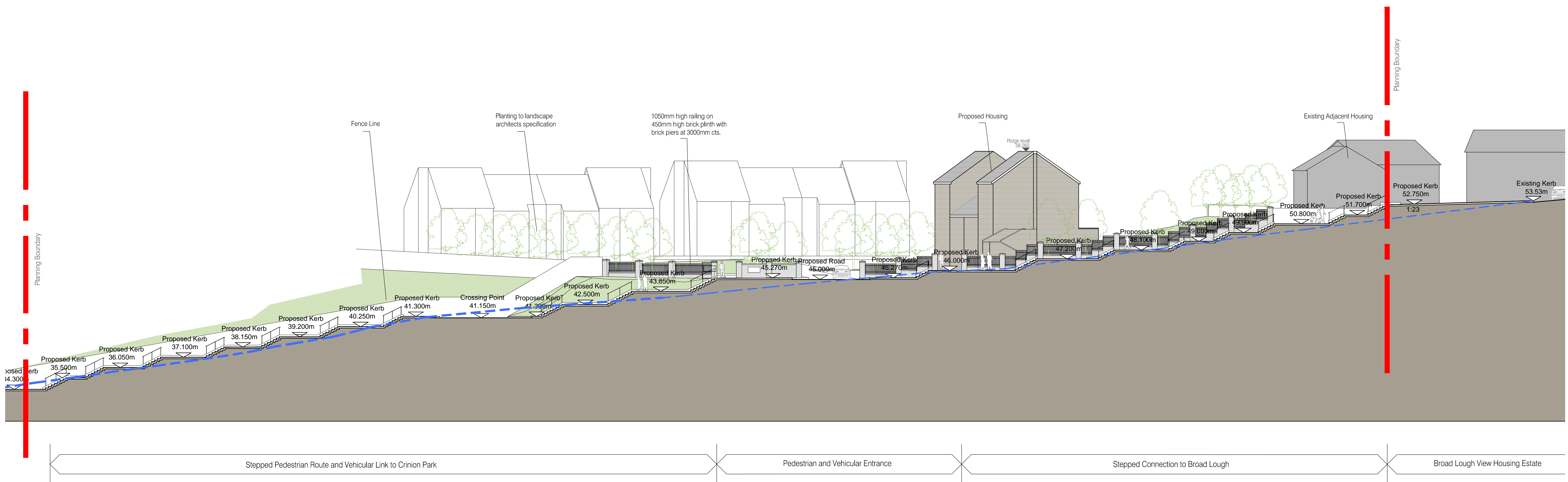

1 Northern Access Road
Scale 1:200

Notes:
Do not scale from this drawing. Use figured dimensions only.
All errors and omissions to be reported to the Architect.
This drawing to be read in conjunction with relevant consultant's drawings.
All dimensions are in millimetres and all levels are in meters to match Datum unless otherwise noted.

Contractor Design responsibility
It is noted that there are many elements within the works that require contractor design, and will be subject to certification as part of BCAR - see Preliminary Inspection Plan for clarity on certification required.

© This drawing or design may not be reproduced without permission.

Rev	Description	Date	By
2	Northern access road shown. Issue for planning	13/04/2017	SL
1	Issue for information	24/03/2017	MH

Project: Proposed development of 51 no. residential units at Radharc an Fharráige, Co. Wicklow on lands formerly known as Convent Land.		Drawing / Document Name: SHB1-CON-AR-COA-DR-0409	
Client: Wicklow County Council		Status: Part 8 Planning	Project Number: 2219
Title: Northern access road		Sheet Number: 0409	Revision: P2
Scale @ A1: 1:200	Drawn: SL	Checked: TS	Date: DEC 2017

COADY ARCHITECTS

Mt Pleasant Business Ctr., Ranelagh, Dublin 6 D06X7P8
4 Carleycon House, Main St., Charlemore, Co. Galway, H91 T026
01 4976766 | 091 78 8325 | admin@coady.ie | www.coady.ie