

for
CHIEF EXECUTIVE

Alan Purcell
nominated officer
St. Decaria

Paul O'Brien
member of visitors
county council

Licence No.
2021/35/CCMA/WicklowCountyCouncil

PRAI Reference
S2021LR007176M.

Vesting Map

Map showing Vesting Area
to be granted to : Wicklow County Council

Land referred to is contained in Plot31b
(WCC CPO Order No.2 1999)
located in Rossana Upper Td

Vesting Area outlined by Red Line and Shaded
Grey
Area of land to be Vested 0.01351Ha (0.0334 acre)

This map is computer
generated from O.S. digital files
plotted in accordance with
with Land Registry Regulations.
L.R. Map 1,2,2a,&3 Appendix B3
Wicklow O.S. Plan:3962-D

NO	INLS	DATE	DESCRIPTION



**WICKLOW
COUNTY
COUNCIL**

JOB :
N11 NEWTOWN TO BALLYNABARNY
ROAD IMPROVEMENT SCHEME

TITLE :
LAND VESTING MAP PLOT 31b

SCALE:
HORIZ = 1:1000
VERT =

Drawn	Checked
Date: May, 2021	

DRAWING NO.:
N11/NBRIS/LVM Plot31b

727518.287mE 696504.362mN

727808.128mE 696504.362mN

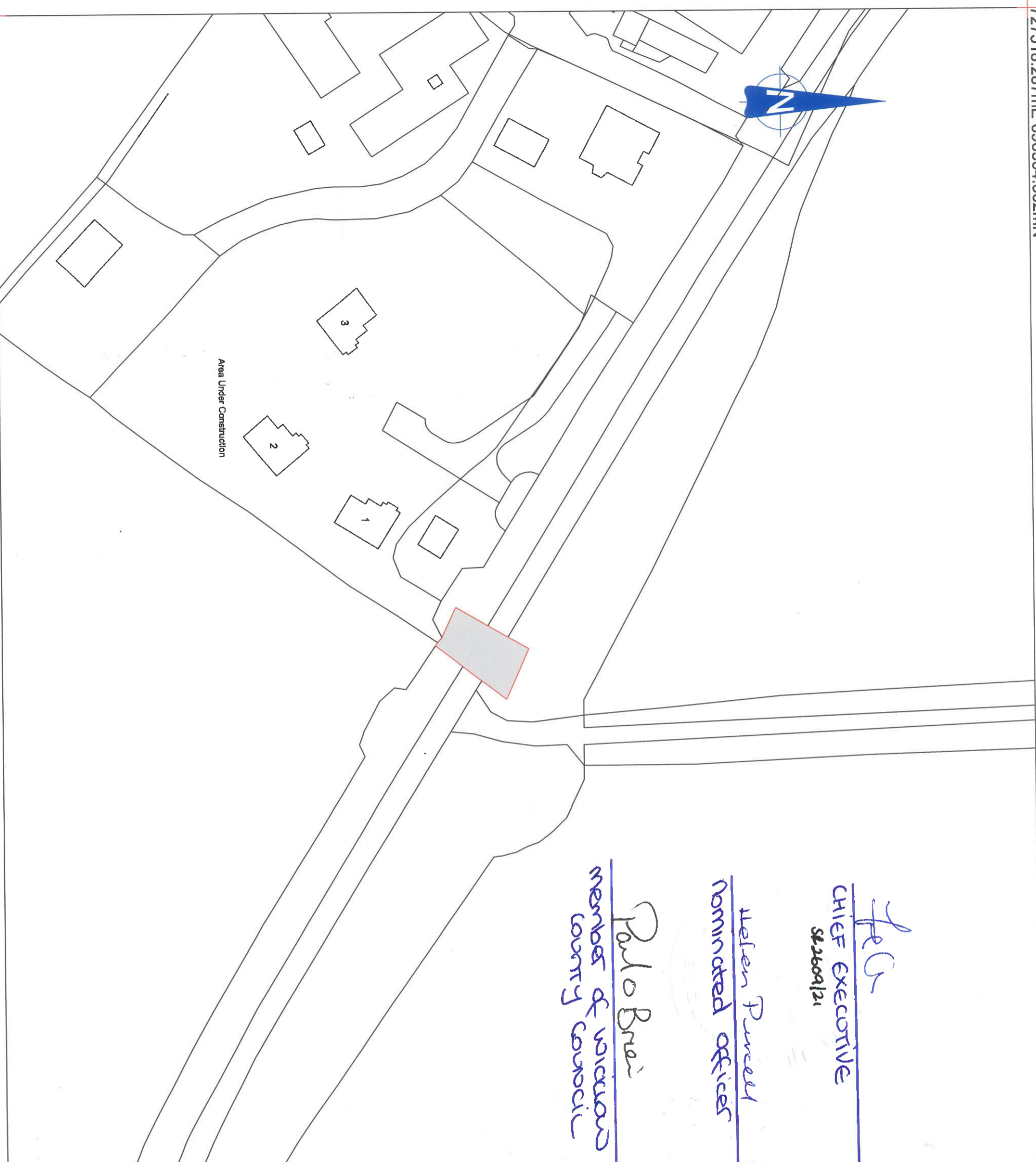

FCU
CHIEF EXECUTIVE
SR 2609/21

Helen Purcell
Nominated officer

Paulo Bnei
member of various
county council

Licence No.
2021/35/CCMA/WicklowCountyCouncil

PRAI Reference
S2021LR007175K.

Vesting Map
Map showing Vesting Area
to be granted to : Wicklow County Council

Land referred to is contained in Plot31a
(WCC CPO Order No.2 1999)
located in Rossana Upper Td.

Vesting Area outlined by Red Line and Shaded
Grey
Area of land to be Vested 0.0263Ha (0.0649 acre)

This map is computer
generated from O.S. digital files
plotted in accordance with
with Land Registry Regulations.
L.R. Map 1.2.2a. &3 Appendix B3
Wicklow O.S. Plan:3962-D

NO	INLS	DATE	DESCRIPTION

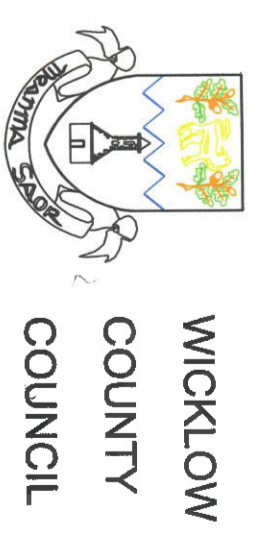

JOB :
N11 NEWTOWN TO BALLYNABARNY
ROAD IMPROVEMENT SCHEME

TITLE :
LAND VESTING MAP PLOT 31a

SCALE:	Drawn	Checked
HORIZ = 1:1000		
VERT =	Date:	May, 2021

DRAWING NO:
N11/NBRIS/LVM Plot31a

727518.287mE 696247.362mN

727442.951mE 704581.529mN

728167.553mE 704581.529mN

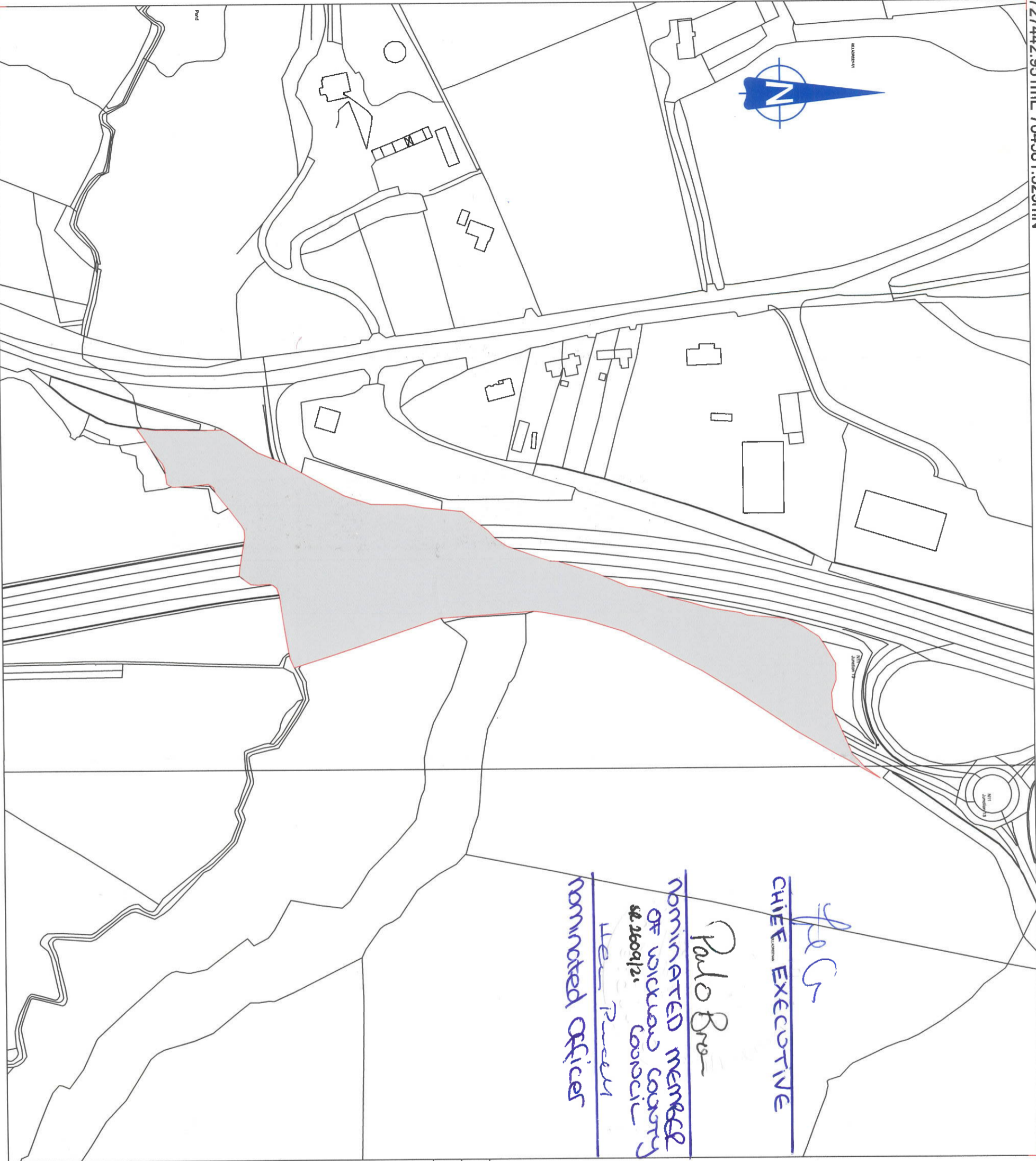

PC
CHIEF EXECUTIVE
Pablo Bro
NOMINATED MEMBER
OF WICKLOW COUNTY
26/04/21
Dea Ruery
NOMINATED OFFICER

Licence No.
2021/35/CCMA/WicklowCountyCouncil

PRAI Reference
S2021LR007362M.

Vesting Map
Map showing Vesting Area
to be granted to : Wicklow County Council

Land referred to is contained in Plot351
(WCC CPO Order No.2 1999)
located in Killadreenan Td & Timmore Td

Vesting Area outlined by Red Line and Shaded
Grey
Area of land to be Vested 2.4812Ha (6.1312 acre)

This map is computer
generated from O.S. digital files
plotted in accordance with
with Land Registry Regulations.
L.R. Map 1,2,2a,&3 Appendix B3
Wicklow O.S. Plans:3848-A,3847-B

NO	INLS	DATE	DESCRIPTION

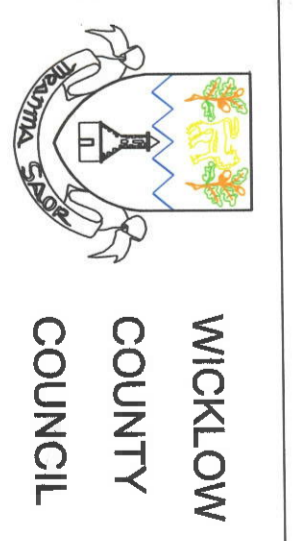

JOB :
N11 NEWTOWN TO BALLYNABARNY
ROAD IMPROVEMENT SCHEME

TITLE :
LAND VESTING MAP PLOT 351

SCALE:
HORIZ = 1:2500
VERT =

Drawn	Checked
Date: May, 2021	

DRAWING NO:
N11/NBRIS/LVM Plot351

727442.951mE 703939.029mN

727581.696mE 704323.838mN

727871.537mE 704323.838mN

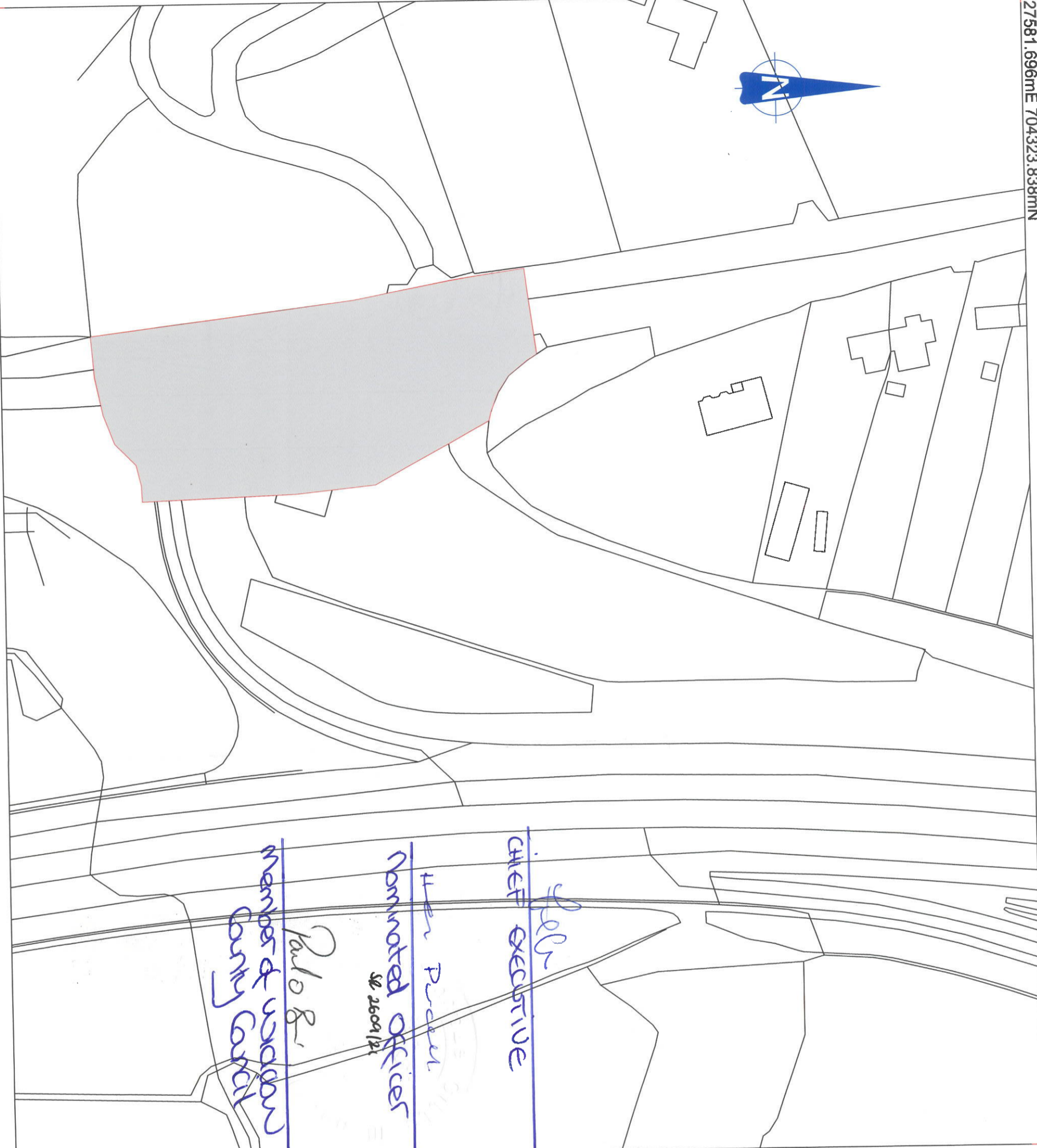

Licence No.
2021/35/CCMA/WicklowCountyCouncil

PRAI Reference
S2021LR007689M.

Vesting Map
Map showing Vesting Area
to be granted to : Wicklow County Council

Land referred to is contained in Plot3m
(WCC CPO Order No.2 1999)
located in Killadreenan Td

Vesting Area outlined by Red Line and Shaded
Grey
Area of land to be Vested 0.4455Ha (1.1008 acre)

This map is computer
generated from O.S. digital files
plotted in accordance with
with Land Registry Regulations.
L.R. Map 1,2,2a,&3 Appendix B3
Wicklow O.S. Plans:3848-A,3847-B

NO	INLS	DATE	DESCRIPTION

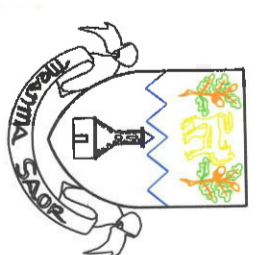

WICKLOW
COUNTY
COUNCIL

JOB :
N11 NEWTOWN TO BALLYNABARNY
ROAD IMPROVEMENT SCHEME

TITLE :
LAND VESTING MAP PLOT 3m(2)

SCALE:
HORIZ = 1:1000
VERT =

Drawn	Checked
Date: May. 2021	

DRAWING NO:
N11/NBRIS/LVM Plot3m(2)

727581.696mE 704066.838mN

727269.885mE 704221.184mN

727994.487mE 704221.184mN

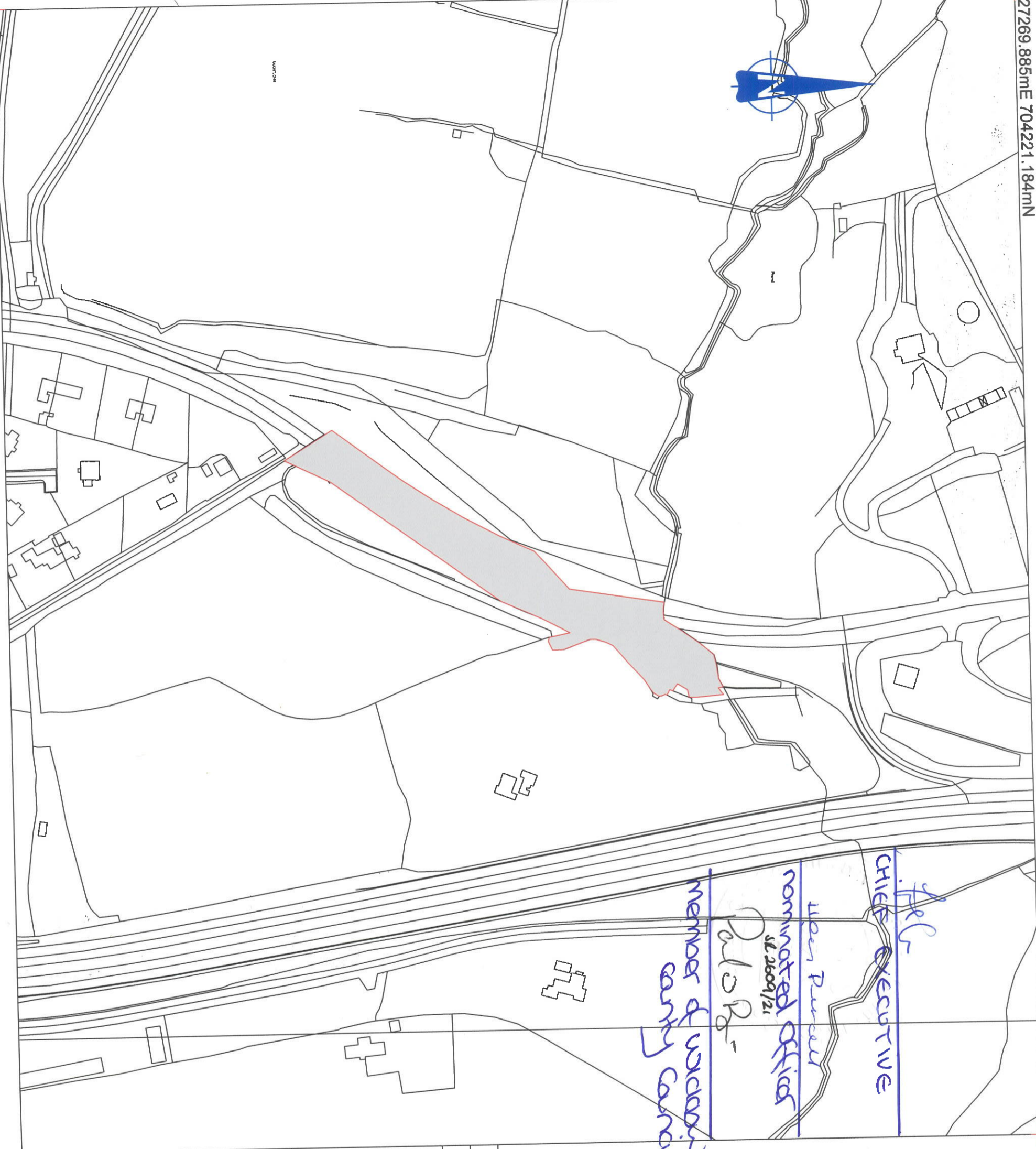

File
CHIEF EXECUTIVE

Upper Pursell
nominated officer
sl 2609/21

Member of Wicklow
County Council
D.J. R.

Licence No.
2021/35/CCMA/WicklowCountyCouncil

PRAI Reference
S2021LR007913X.

Vesting Map
Map showing Vesting Area
to be granted to : Wicklow County Council

Land referred to is contained in Plot3j
(WCC CPO Order No.2 1999)
located in Timmore Td

Vesting Area outlined by Red Line and Shaded
Grey
Area of land to be Vested 0.9534Ha (2.356 acre)

This map is computer
generated from O.S. digital files
plotted in accordance with
with Land Registry Regulations.
L.R. Map 1.2.2a.&3 Appendix B3
Wicklow O.S. Plans:3848-A,3847-B

NO	INLS	DATE	DESCRIPTION

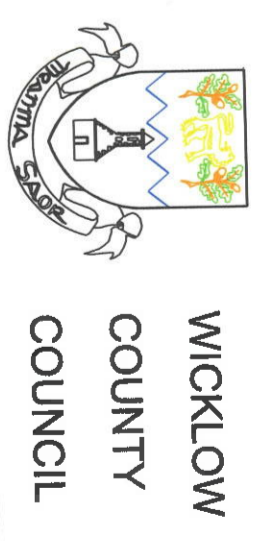

JOB :
N11 NEWTOWN TO BALLYNABARNY
ROAD IMPROVEMENT SCHEME

TITLE :
LAND VESTING MAP PLOT 3j

SCALE:
HORIZ = 1:2500
VERT =
Drawn
Checked
Date: May, 2021

DRAWING NO:
N11/NBRIS/LVM Plot3j

727269.885mE 703578.684mN

727581.696mE 704323.838mN

727871.537mE 704323.838mN

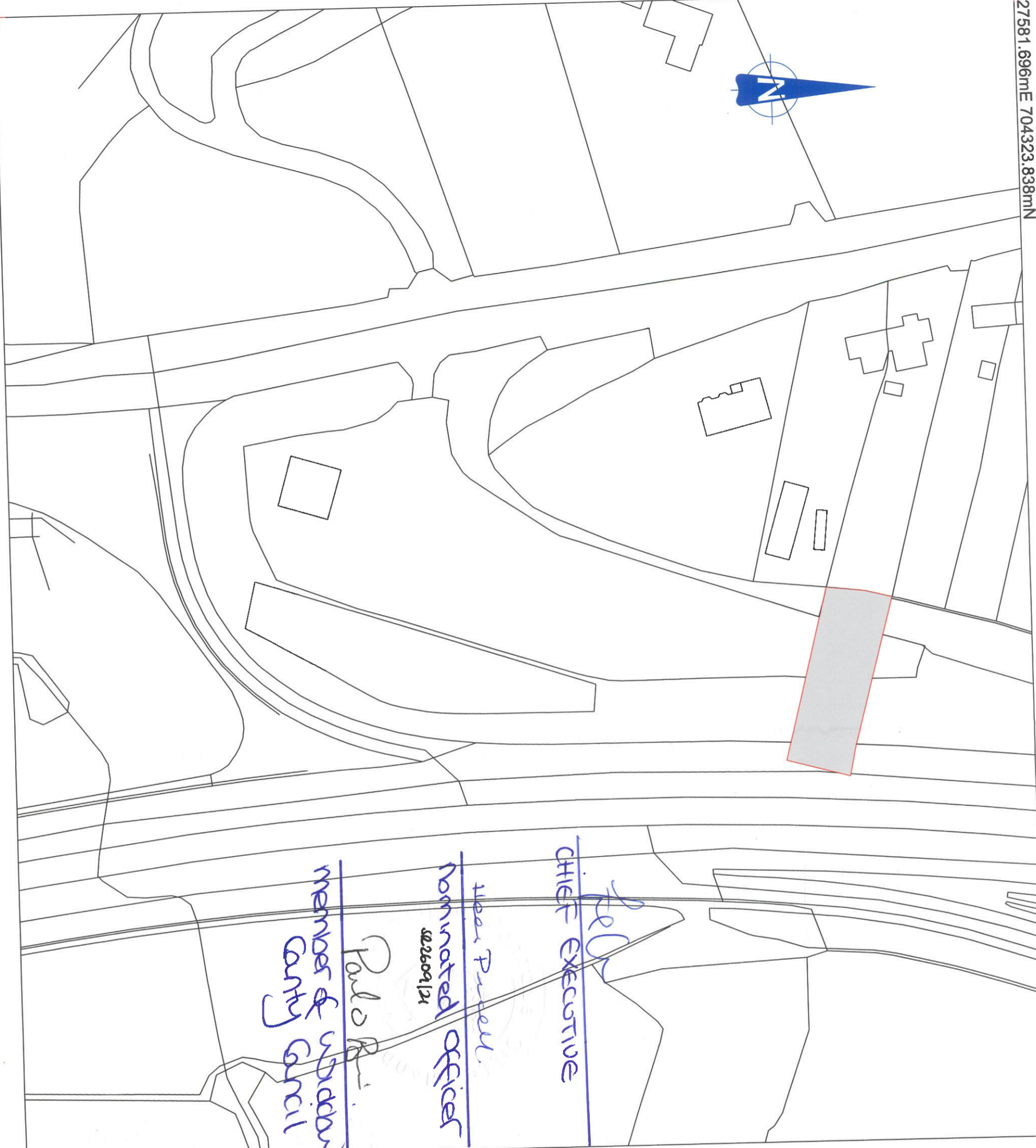

Licence No.
2021/35/CCMA/WicklowCountyCouncil

PRAI Reference
S2021LR007621M

Vesting Map
Map showing Vesting Area
to be granted to : Wicklow County Council

Land referred to is contained in Plot3m
(WCC CPO Order No.2.1999)
located in Killadreenan Td

Vesting Area outlined by Red Line and Shaded
Grey
Area of land to be Vested 0.0762Ha (0.1882 acre)

This map is computer
generated from O.S. digital files
plotted in accordance with
with Land Registry Regulations.
L.R. Map 1.2.2a.&3 Appendix B3
Wicklow O.S. Plans:3848-A,3847-B

NO	INLS	DATE	DESCRIPTION

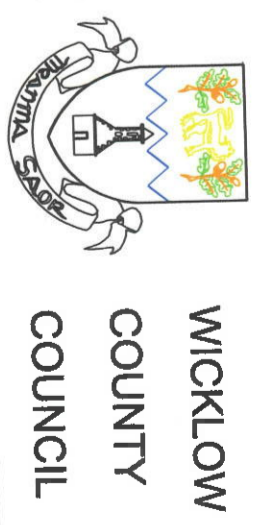

**WICKLOW
COUNTY
COUNCIL**

JOB :
N11 NEWTOWN TO BALLYNABARNY
ROAD IMPROVEMENT SCHEME

TITLE :
LAND VESTING MAP PLOT 3m(1)

SCALE:	Drawn	Checked
HORIZ = 1:1000		
VERT =	Date:	May. 2021

DRAWING NO:
N11/NBRIS/LVM Plot3m(1)

John P. O'Rourke
CHIEF EXECUTIVE

John P. O'Rourke
Nominated officer
S22609/21

Paul O'Rourke
member of visitors
County Council

727581.696mE 704066.838mN

Comhairle Chill Mhantáin

Wicklow County Council

SECTION 76 OF THE THIRD SCHEDULE TO THE HOUSING ACT, 1966, AS EXTENDED BY SECTION 10 OF THE LOCAL GOVERNMENT (NO. 2) ACT, 1960, AS AMENDED BY LOCAL GOVERNMENT (PLANNING AND DEVELOPMENT) ACTS, 1963- 1992 (AS AMENDED)

SECTION 10 OF THE LOCAL GOVERNMENT (IRELAND) ACT, 1898, AS AMENDED BY SECTION 11 OF THE LOCAL GOVERNMENT (NO.2) ACT, 1960, AND LOCAL GOVERNMENT (PLANNING AND DEVELOPMENT) ACTS, 1963 – 1992 (AS AMENDED)

WICKLOW COUNTY COUNCIL COMPULSORY PURCHASE (NEWTOWNMOUNTKENNEDY TO BALLYNABARNEY ROAD IMPROVEMENT SCHEME) NO. 2 ORDER, 1999

WICKLOW COUNTY COUNCIL VESTING ORDER NO. 3 OF 2021

Whereas the land described in the Schedule hereto and shown on Vesting Map Numbers **N11/NBRIS/LVM Plot 35I, N11/NBRIS/LVM Plot 3m(1), N11/NBRIS/LVM Plot 3m(2), N11/NBRIS/LVM Plot 3j, N11/NBRIS/LVM Plot 31a, N11/NBRIS/LVM Plot 31b** attached hereto and outlined with a red line and sealed with the seal of Wicklow County Council (hereinafter referred to as “the local authority”) is land to which the Wicklow Council Compulsory Purchase (**NEWTOWNMOUNTKENNEDY TO BALLYNABARNEY ROAD IMPROVEMENT SCHEME) NO. 2 ORDER, 1999** relates, and the said order has become operative in so far as it relates to the said land:

And whereas the local authority have, at least six months prior to the date of this order, entered on and taken possession of the said land in accordance with the powers conferred upon them by Section 80 of the Housing Act, 1966, as applied by Section 10 of the Local Government (No. 2) Act, 1960 (as substituted by section 86 of the Housing Act, 1966):

And whereas:

- (a) the several interests in the said land have not been conveyed or transferred to the local authority,
- (b) the local authority consider that it is urgently necessary, in connection with the purposes for which they have been authorised to acquire the land compulsorily, that the acquisition of the land should be completed, and
- (c) the local authority have made a proper offer in writing to each person having an interest in the said land who has furnished sufficient particulars of his interest to enable it to make a proper offer for such interest:

NOW THEREFORE the local authority in exercise of the powers conferred upon them by section 81 of the Housing Act, 1966, as applied by Section 10 of the Local Government (No. 2) Act, 1960, as substituted as aforesaid, shall, on the 1st December, 2021 vest in the local authority in fee simple free from encumbrances and all estates, rights, titles and interests of whatsoever kind (other than any public right of way).

Wicklow County Council Vesting Order No. 3 of 2021
Schedule

Map No. deposited at the offices of the Local Authority		Quantity, description and situation of the land			Owners or reputed Owners	Lessees or reputed Lessees	Occupiers (except tenants for a month or for less period than a month)
		Area in Ha & acre	Townland	Description of Property			
Drawing No.	Plot No.						
N11/NBRIS/LVM Plot 35I	35I	2.4812Ha 6.1312acre	Killadreenan Td & Timmore Td	Public road/road bed	Walter Zeig & Liselott Zeig		Wicklow County Council
N11/NBRIS/LVM Plot 3m(1)	3m	0.0762Ha 0.1882acre	Killadreenan Td	Public road/road bed	Wicklow County Council		Wicklow County Council

N11/NBRIS/LVM Plot 3m(2)	3m	0.4455Ha 1.1008acre	Kiladreenan Td	Public Road/road bed	Wicklow County Council	Wicklow County Council
N11/NBRIS/LVM Plot 3j	3j	0.9534Ha 2.356acres	Timmere Ld	Public road/road bed	Wicklow County Council	Wicklow County Council
N11/NBRIS/LVM Plot 31a	31a	0.0263Ha 0.0649acre	Rossana Upper Td	Public road/road bed	Catherine Flood Vincent Doyle & Hannah Doyle	Wicklow County Council
N11/NBRIS/LVM Plot 31b	31b	0.0135Ha 0.0334acre	Rossana Upper Td	Public road/roadbed	Catherine Flood Vincent Doyle & Hannah Doyle	Wicklow County Council

The official seal of the local authority was affixed hereto this day 8th November, 2021 in the presence of:

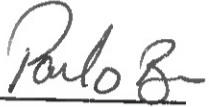
Cathaoirleach/
Nominated Member

Chief Executive

Nominated Employee
SR 2609/21